

IEC CLASS SUSPENSION DISC INSULATOR

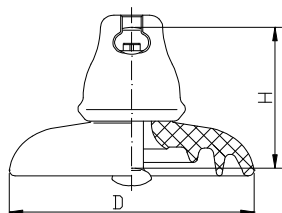

FIG. 1

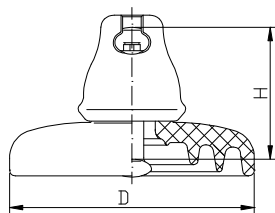

FIG.2

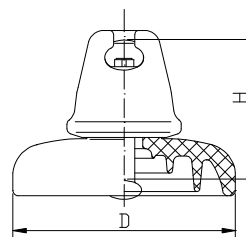

FIG.3

STANDARD TECHNICAL CHARACTERISTICS

Cat. No.		0104160BL	0104160BS	0104160BS-1	0104160BL-1	0104160BL-2
Class		U160BL	U160BS	U160BS	U160BL	U160BL
Fig. No.		1	1	1	2	3
Unit Spacing (H) -mm		255	255	280	300	255
Coupling size		20	20	20	20	20
Nominal Creepage Distance-mm		305	320	315	400	390
Rated E& M Failing Load-KN		160	160	160	160	160
Routine Tensile Load-KN		80	80	80	80	80
Impact Strength -N.m		10	10	10	10	10
Power Frequency Withstand	Wet-KV	40	40	45	45	40
	Dry-KV	70	70	75	75	70
Dry Lighting Impulse Withstand Voltage-KV		110	110	110	110	110
Power Frequency Puncture Voltage - KV		110	110	110	110	110
Radio Interference Voltage	Test Voltage to Ground-KV	10	10	10	10	10
	Max. RIV at 1MHz-uV	50	50	50	50	50
Weight -kg		7.0	7.2	7.6	8.3	7.6