

IEC CLASS STATION POST INSULATOR

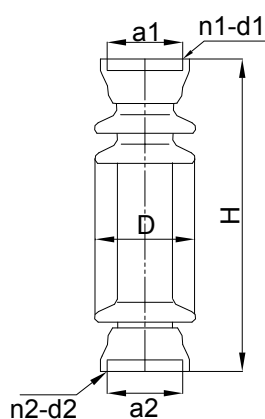

**STANDARD TECHNICAL CHARACTERISTICS**

IEC Class	Nominal Voltage (KV)	Cantilever Strength (KN)	Torsion Strength KN.m	Creepage Distance mm	Impulse Withstand Voltage (KV)	Power Freq. Dry Withstand Voltage (KV)	Power Freq. Wet Withstand Voltage (KV)	Weight kg
C <sub>4</sub> -170w	35	4	1.2	875	170	100	70	13
C <sub>4</sub> -250w	35	4	1.8	1260	250	135	90	27
C <sub>6</sub> -250	63	6	2	1160	250	135	90	38
C <sub>4</sub> -325	63	4	2	1104	325	175	140	29
C <sub>12.5</sub> -325	63	12.5	2	1104	325	175	140	61
C <sub>4</sub> -325w	63	4	4	2010	325	175	140	50
C <sub>8</sub> -325w	63	8	4	1308	325	175	140	55
C <sub>4</sub> -170w	35	4	4	875	170	100	70	14
C <sub>4</sub> -170w	35	4	4	875	170	100	70	13.5
C <sub>10</sub> -25w	35	10	4	1260	250	135	90	31.4

**MAIN DIMENSIONS**

Height H	Max Dia	Dry Arcing Distance mm	Shed Number	Top PCD n <sub>1</sub> -d <sub>1</sub> -a <sub>1</sub>	Bottom PCD n <sub>2</sub> -d <sub>2</sub> -a <sub>2</sub>
445	150	345	10	4-Φ14-Φ140	4-Φ14-Φ140
560	235	405	9	4-M16-Φ127	4-Φ14-Φ180
710	180	565	11	4-M12-Φ140	4-Φ18-Φ225
760	170	627	10	4-M12-Φ140	4-Φ14-Φ180
840	230	628	9	4-M18-Φ210	8-Φ18-Φ250
850	235	705	15	4-M12-Φ140	4-Φ18-Φ225
850	235	705	12	4-M12-Φ140	4-Φ18-Φ225
445	150	350	10	4-M12-Φ140	4-Φ14-Φ180
445	150	351	10	4-M12-Φ140	4-M12-Φ140
560	245	405	9	4-M16-Φ127	4-Φ14-Φ180