

ANSI CLASS PIN TYPE INSULATOR
[ANSI 56-2 TWO DESIGNS]

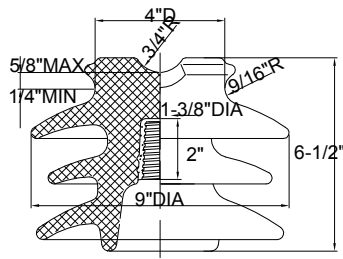

FIG. 1

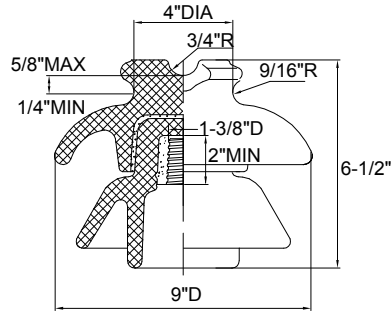

FIG. 2

56-2

STANDARD TECHNICAL CHARACTERISTICS

Cat. No.		0401562	
ANSI Class		56-2	
Fig. No.		FIG.1 & FIG.2	
Insulator Type		Plain	Radio Freed
Neck Designation in accordance with ANSI C29.6		K	
Voltage Rating (U.S.Practice) /KV		23	
Leakage Distance/in (mm)		17(432)	
Dry Arcing Distance/in (mm)		8-1/4(210)	
Minimum Pin Height/in (mm)		7(178)	
Cantilever Strength/Average/lb (kN)		3,000(13)	
Average Flashover Voltage	Low-frequency	Dry/kV	110
		Wet/kV	70
Voltage	Critical-impulse	Positive/kV	175
		Negative/kV	225
Low Frequency Puncture Voltage/Average/kV		145	
Radio-Influence	Test Voltage to Ground/kV		22 22
Voltage Date	Maximum RIV at 1,000kHz/μV		12,000 100
Net Weight/lb		11	

NOTE:1.Surfaces coated with semi-conductive glaze are considered as effective leakage surfaces and the distance over them is included in the leakage distance.

2.The side-wire groove has a diameter of 1-1/16 inches. The top-wire groove has a diameter of 1-7/16 inches.