

ANSI CLASS PIN TYPE INSULATOR  
[ANSI 55-3,55-4 & 55-5]

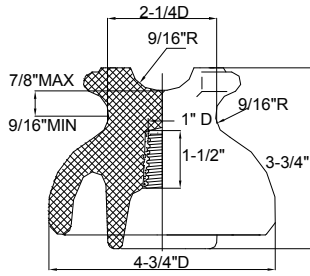

55-3

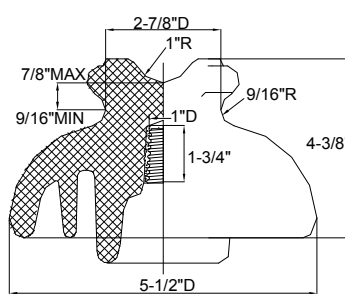

55-4

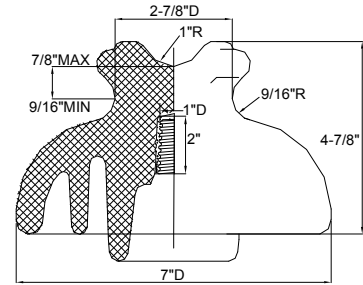

55-5

STANDARD TECHNICAL CHARACTERISTICS

Cat. No.		0401553		0401554		0401555		
ANSI Class		55-3		55-4		55-5		
Insulator Type		Plain	Radio Freed	Plain	Radio Freed	Plain	Radio Freed	
Neck Designation(ANSI C29.5)		C		F		F		
Voltage Rating (U.S.Practice)/KV		7(178)		9(229)		12(305)		
Leakage Distance/in (mm)		4-1/2(114)		5(127)		6-1/4(159)		
Dry Arcing Distance/in (mm)		5(127)		5(127)		6(152)		
Cantilever Strength/Average/lb (kN)		2,500(11)		3,000(13)		3,000(13)		
Average Flashover Voltage	Low-frequency	Dry/kV	65	55	70	65	85	80
		Wet/kV	35	30	40	35	45	45
	Critical-impulse	Positive/kV	100	90	110	105	140	130
		Negative/kV	130	110	140	130	170	150
Low Frequency Puncture Voltage/Average/kV		90		95		115		
Radio-influence Voltage Date	Test Voltage to Ground/kV	10	10	10	10	15	15	
	Maximum RIV at 1,000kHz/μV	5,500	50	5,500	50	8,000	100	
Net Weight/lb		2.4		3.7		6.4		

NOTE:

- 1.Surfaces coated with semi-conductive glaze are considered as effective leakage surfaces and the distance over them is included in the leakage distance.
- 2.The side-wire groove has a diameter of 1-1/16 inches. The top-wire groove has a diameter of 1-3/4 inches.